





contents

3. about
4. the Atrium
5. the Helene and Johannes Huth Gallery
6. the Sachs Family Park Room
7. the Chumsri and Luqman Lounge
8. the Plaza
9. options
11. frequently asked questions
12. approved suppliers
15. contact

about

The Design Museum, the world's leading museum devoted to architecture and design, which has hosted leading brand and fashion events for decades, is now exclusively available for a limited number of wedding ceremonies and celebrations a year.

Located in a landmark grade II listed modernist building in the heart of Holland Park, Kensington, the Design Museum offers five unique and memorable spaces for marriages, civil partnerships and celebrations.

To find out more, please contact the events team. They will guide you through the space options, timings, fees, approved suppliers and availability.

The museum is a registered charity governed by a board of trustees. By hosting your celebration at the Design Museum, you are contributing to the museum's vision of helping everyone understand the value of design.



the Atrium

The Atrium is the museum's largest space, holding up to 750 guests across three open levels. It can be hired for wedding ceremonies, drinks receptions and dinner dances.

It is a bright and dramatic space, with balconies offering open views of the museum and its original, hyperbolic paraboloid roof.

It acts as a blank canvas that you can transform into your vision by working with our trusted, approved suppliers.

As this space is open to the public during the day, ceremonies can start from 19:00, or you can use another room for an earlier ceremony and the Atrium for dinner and dancing.

Hire of the Atrium includes use of the Plaza for early evening drinks until 20:30.

Capacity

200 ceremony

750 standing reception

150 dinner dance



the Helene and Johannes Huth Gallery

The Helene and Johannes Huth Gallery is on the second floor of the museum with incredible views over Holland Park.

It is a sleek and versatile space with retractable walls and the option of all day hire, ideal for day-time ceremonies or set ups that require additional time to set up.

Capacity

200 ceremony

100 ceremony, reception and lunch

220 standing reception

200 seated lunch/ dinner

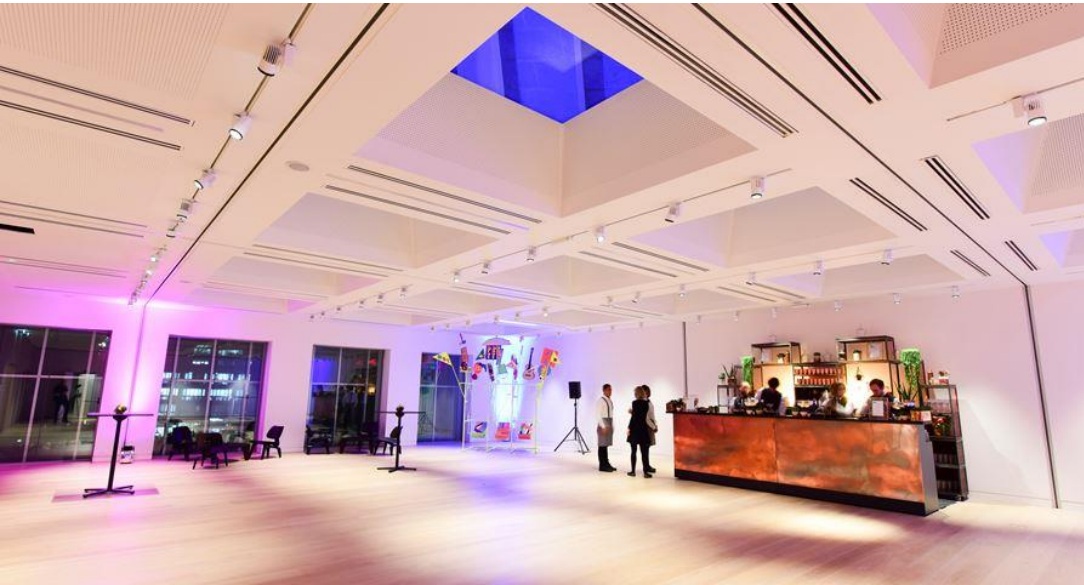



the Sachs Family Park Room

The Sachs Family Park Room is located on the third floor of the Museum. With full length windows and impressive views of Holland Park, it glows in natural light.

This room can be used for medium sized ceremonies and celebrations, or in conjunction with the Atrium for a larger evening reception.



Capacity

100 ceremony

50 ceremony, reception and lunch

120 standing reception

100 seated lunch/ dinner

the Chumsri and Luqman Lounge

Designed by Universal Design Studio, the Chumsri and Luqman Lounge features a polished pewter bar, mirrored walls, Barber Osgerby designed furniture and a unique collection of Philip Sayer photographs featuring 30 legendary designers.

It is ideal for smaller day time ceremonies and celebrations and can also be hired as a private room in addition to the other spaces.

Capacity

20 ceremony

20 ceremony, reception and lunch

45 standing reception

32 dinner

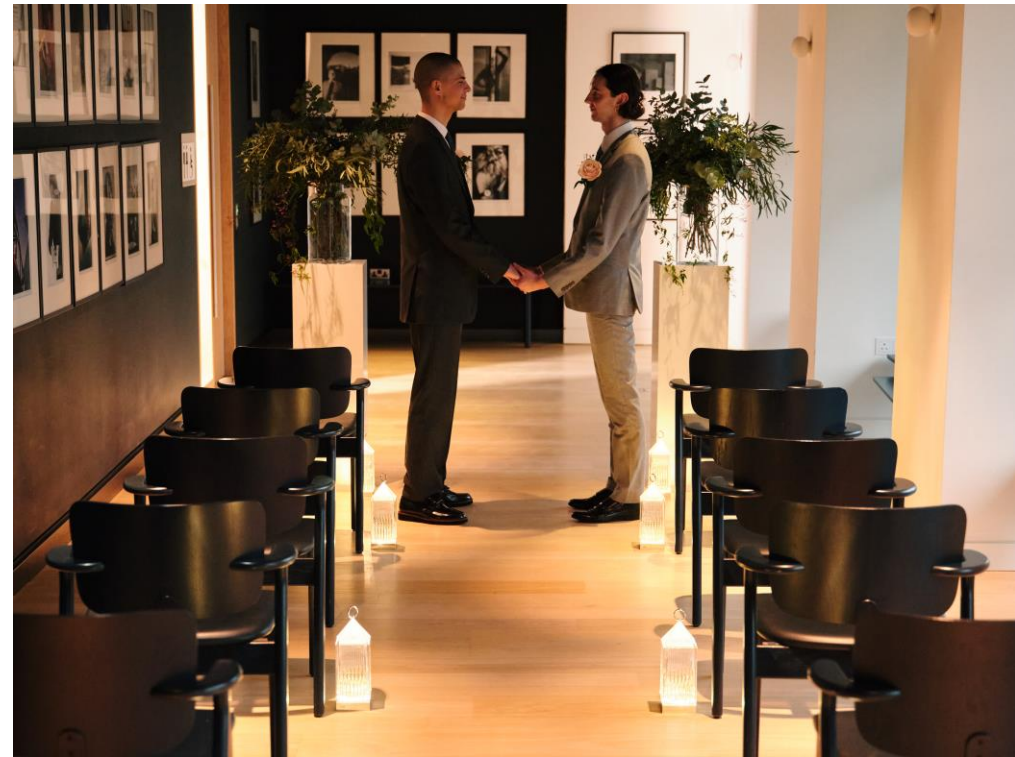



the Plaza

The Design Museum has recently launched its new outside space, the Plaza, offering beautiful views of one of London's most loved green spaces, Holland Park, making it the perfect setting for early evening drinks.

Capacity
100 standing

The Plaza can only be hired until 20:30 and is not available for civil marriage or partnership ceremonies.

options

To help you get a feel for the day, we have created three options that we find work well for wedding couples. Please contact our Events Team to discuss the options and they will put a quote together especially for you.

Option 1, Ceremony and Drinks Reception (up to 100 guests)

Example timings:

09:00 Supplier access to set up

11:30* Couple, bridal party and registrar arrive

12:00 Guests arrive for ceremony

12:30 Ceremony starts

13:00 Drinks and canapés (or lunch) served
Photos in designated museum areas

14:30 Event ends

* Three-hour bookings any time within the hours of 11:00 and 17:00 (latest starting at 14:00)

Hire fee:

Up to 20 guests: £3,000 plus vat (Chumsri and Luqman Lounge)

Up to 100 guests: £6,000 plus vat (Helene and Johannes Huth Gallery)

Option 2, Reception and Dinner Dance (up to 150 guests)

Example timings:

12:00 Supplier access to set up

17:00 Couple and guests arrive

Drinks and canapés served in the Helene and Johannes Huth Gallery

Photos in designated museum areas

19:00 Call to dinner in the Atrium

20:30 Speeches and cake cutting

21:00 First dance in the Atrium

23:30 Bar closes and music ends

00:00 Event ends

Hire fee: £14,000 plus vat



options

Option 3, Ceremony, Reception and Dinner Dance (up to 150 guests)

Example timings:

12:00 Supplier access to set up

16:00 Couple, bridal party and registrar arrive

16:30 Guests arrive for ceremony in the Helene and Johannes Huth Gallery

17:00 Ceremony starts

17:30 Drinks and canapés served

Photos in designated museum areas

19:00 Call to dinner in the Atrium

20:30 Speeches and cake cutting

21:00 First dance in the Atrium

23:30 Bar closes and music ends

00:00 Event ends

Hire fee: £15,000 plus vat

All prices are subject to vat.

Guest timings are approximate and depend on the amount of setup required.

Set up in the Atrium is from 18:00.

Hire fees are for the spaces only, please see FAQs for what is included.

Bookings are subject to the Design Museum's T&Cs, available from the Events Team.



frequently asked questions

Is the Museum licenced for marriages and civil partnership ceremonies?

All of the spaces listed are licenced for marriages and civil partnership ceremonies. We will connect you with the Royal Borough of Kensington and Chelsea to book your registrar (their contact details can be found on p15). Please note, this is a separate cost to the venue hire fee.

What is included in the venue hire fee?

The hire fee includes exclusive use of your chosen event spaces, a venue hire manager, security staff, cleaning staff and an onsite electrician. Other costs to consider are planner, catering, production (for lighting, audio visual and dance floor), flowers and entertainment from the approved list.

Do we have to use a wedding planner?

You must have a planner on the day itself. This is so that you can focus on enjoying the day, while your experienced planner oversees the coordination. All of our approved planners offer full planning services or lead in/on the day support.

Can we use our own suppliers?

Due to the nature of the building and short set up times, you must work with our approved list of suppliers. This ensures the Museum is protected and you receive the highest, most knowledgeable service from suppliers who know the Museum inside out and are best placed to bring your vision to life.

Can we supply our own drinks?

You are welcome to provide your own drinks. We don't charge a corkage fee but your supplier will charge an amount to chill, deliver, hire glasses and serve the drink.

Can we dance in the museum?

You are welcome to dance but there needs to be a dance floor. This can be arranged through one of our approved production companies.

Are there any restrictions in the museum?

As a listed building, fireworks, sparklers, confetti, helium balloons, naked flames and dry ice are not permitted in the museum or garden. Due to the floors and collection, red wine can only be served at seated dinners.

Do we have to end at midnight?

The end time can be extended until 01:00, subject to licence availability and at an additional £2,000 plus vat.



approved suppliers

The Design Museum's suppliers are carefully selected.

They are all experienced at working within the listed building and to the relevant set up and pack down times, therefore we ask that all your suppliers are chosen from this list.

Please contact us if you would like to discuss the list in more detail.

planning

catering

The Golborne Collection

Natalia Hollingsworth

07899 935776

natalia@thegolbornecollection.com

www.thegolbornecollection.com

Design Museum Events

Catering

Matt Haigh

events.catering@designmuseum.org

Lucy Meehan Events Ltd

Lucy Meehan

07508 040494

l.meehan@lucymeehanevents.co.uk

www.lucymeehanevents.co.uk

By Word of Mouth

Rick Perry

020 8871 9566

events@bywordofmouth.co.uk

www.bywordofmouth.co.uk

Rebecca K Events

Rebecca Kobus

020 7378 0101

hello@rebeccakevents.com

www.rebeccakevents.com

Last Supper

Jonathan Attwood

020 7378 0101

info@lastsupperltd.co.uk

www.lastsupperltd.co.uk

Rocket

Charlie Grant-Peterkin

020 7622 2320

parties@rocketfood.com

www.rocketfood.com

@optionsgreathire



approved suppliers

production (sound, lighting, dance floor)

Event Concept

Craig Irvine
020 7740 3988
craig.irvine@eventconcept.co.uk
www.eventconcept.co.uk

Light Motif

Rob Mills
020 7183 5381
rob@lightmotif.co.uk
www.lightmotif.co.uk

Fisher Productions

Tristan Leonard
020 8871 1978
enquiries@fisherproductions.co.uk
www.fisherproductions.co.uk

Storm

Emma Gallagher
0148 3757 211
emma.gallagher@stormltd.co.uk
www.stormltd.co.uk

Focus Lighting and Productions Ltd

Dom Watson
020 8542 9221
dom@focuslighting.co.uk
www.focuslighting.co.uk

Wise Productions

Doug Wintle
020 8991 6922
events@wiseproductions.co.uk
www.wiseproductions.co.uk





approved suppliers

flowers

Lavender Green Flowers

020 7127 5303

info@lavendergreen.co.uk

www.lavendergreen.co.uk

Pinstripes and Peonies

Ruari McCulloch

020 7720 1245

flowers@pinstripesandpeonies.com

www.pinstripesandpeonies.com

Simon Lycett

020 7277 3322

enquiries@simonlycett.co.uk

www.simonlycett.co.uk

Veevers Carter

Lex Falley

020 7740 3988

lex.falley@veeverscarter.com

www.veeverscarter.com

entertainment

Prelude Entertainment

Ashley Prout

020 8660 6647

ashley@preludeentertainment.co.uk

www.preludeentertainment.co.uk

Young Guns

020 7495 6606

hello@younggunsgroup.com

www.younggunsgroup.com

contact

Please contact our dedicated events team to find out more about holding your wedding or celebration at the Design Museum.

the Design Museum Events Team

020 3862 5907

venuehire@designmuseum.org

To book your registrar, please contact:

Kensington and Chelsea Register Office

020 7361 4100

registrars@rbkc.gov.uk

www.rbkc.gov.uk/registrars

the Design Museum is located at

224-238 Kensington High Street London,
W8 6AG

nearest transport

Underground: High Street Kensington,
Earl's Court and Holland Park

Overground: Kensington/Olympia

